

Hanover Industrial Estates

Hanover Township • Luzerne County • Pennsylvania



newPA.com | 866•GO•newPA

Corporate Neighbors – North

- Lot 1 Available/optioned
- Lot 1A Available
- Lot 2A Hanover Townhomes
- Lot 2C Luzerne County 911 Communications Center
- Lot 3 NEPIRC
- Lot 3A U.S. Postal Service
- Lot 3B Magic Years Childcare & Learning Center
- Lots 4/5 Harte-Hanks Direct Marketing/Wilkes-Barre
- Lot 6A Altria Group, Inc. (Distribution Center)
- Lot 7 Integrated Power Design, Inc.
- Lot 7A BabyAge
- American Homepatient
- Lot 7B Blue Falls Apparel, Inc.
- Lot 8A Koehler-Bright Star, Inc.
- Lot 8B UGI Electric Utilities
- Lot 9 Safety Kleen, Inc.
- Lot 9A/B Carpenter Engineered Products
- Lot 9C VicWest Steel
- Lot 10A Chaucer Press, Inc.
- Lot 10B Bekins - A-1 Moving, Inc.
- Lot 10C – Mericle Flex Building – Communications Test Design, Inc. Aramark Uniform & Career Apparel, Inc. Itoh Denki USA, Inc. PharMerica Drug Systems, Inc. Serv-A-Lite Products, Inc. Manchester Industries
- Lot 10D – Mericle Flex Building – 22,600 SF Available
- Lot 10E New Horizons Computer Learning Center of Wilkes-Barre/Scranton UniFirst Corporation
- Lot 10F Karol Media
- Lot 10H/1 Bertels Can Company
- Lot 11 Luzerne County Rail Authority
- Lot 12A Cavanaugh Electric
- Lot 12B Nardone Brothers Baking Company
- Lot 13B – Mericle Flex Building – Office Furniture USA, Inc. PA LCB Creditek, LLC
- Lot 14 Lasco Fittings, Inc.
- Lot 15 CCL Plastic Packaging
- Lot 16 SallieMae
- Lot 17 Keyco Distributors, Inc.
- Lot 18 Hanover Township
- Lot 19 Huttig Building Products
- Lot 20, 21, 22 Alexandria Mouldings, Inc.
- Lot 23 AT&T
- Lot 24 Bedwick & Jones Printers
- Lot 25 J.M. Callahan & Sons, Inc.
- Lot 26 Available
- Lot 27 Bridon American Corporation
- Lot 28 Modern Handling Company
- Lot 29 Telerx
- Lot 30/32 Altria Group, Inc.
- Lot 31 American Red Cross
- Lot 33 Hershey Creamery Company
- Lot 34 North End Electric
- Lot 35 U.S. Army Reserve Center

Corporate Neighbors – South

- Lot 1 Sears Logistics Services, Inc.
- Lot 3 Sid Harvey's
- Lot 4 – Mericle Flex Building – Rafatac Entertainment Distribution Company
- Lot 5/6 Sears Logistics Services, Inc. #2
- Lot 7 – Mericle Flex Building – Bell Atlantic FedEx Ground Choice One Communications of PA, Inc. Mericle Construction
- Lot 8 – Mericle Flex Building – Whiteman Tower Thales Broadcast & Multimedia Yellowbook
- Lot 9 PA State Police/Driver's License Center Penn Warranty Company
- Lot 10 Sears Logistics Services, Inc. #3
- Lot 11A – Mericle Flex Building – 12,000 SF Available Amersham Health Bath Fitter Cintas Harrisburg News IMS Patterson Dental Supply, Inc. Travelocity

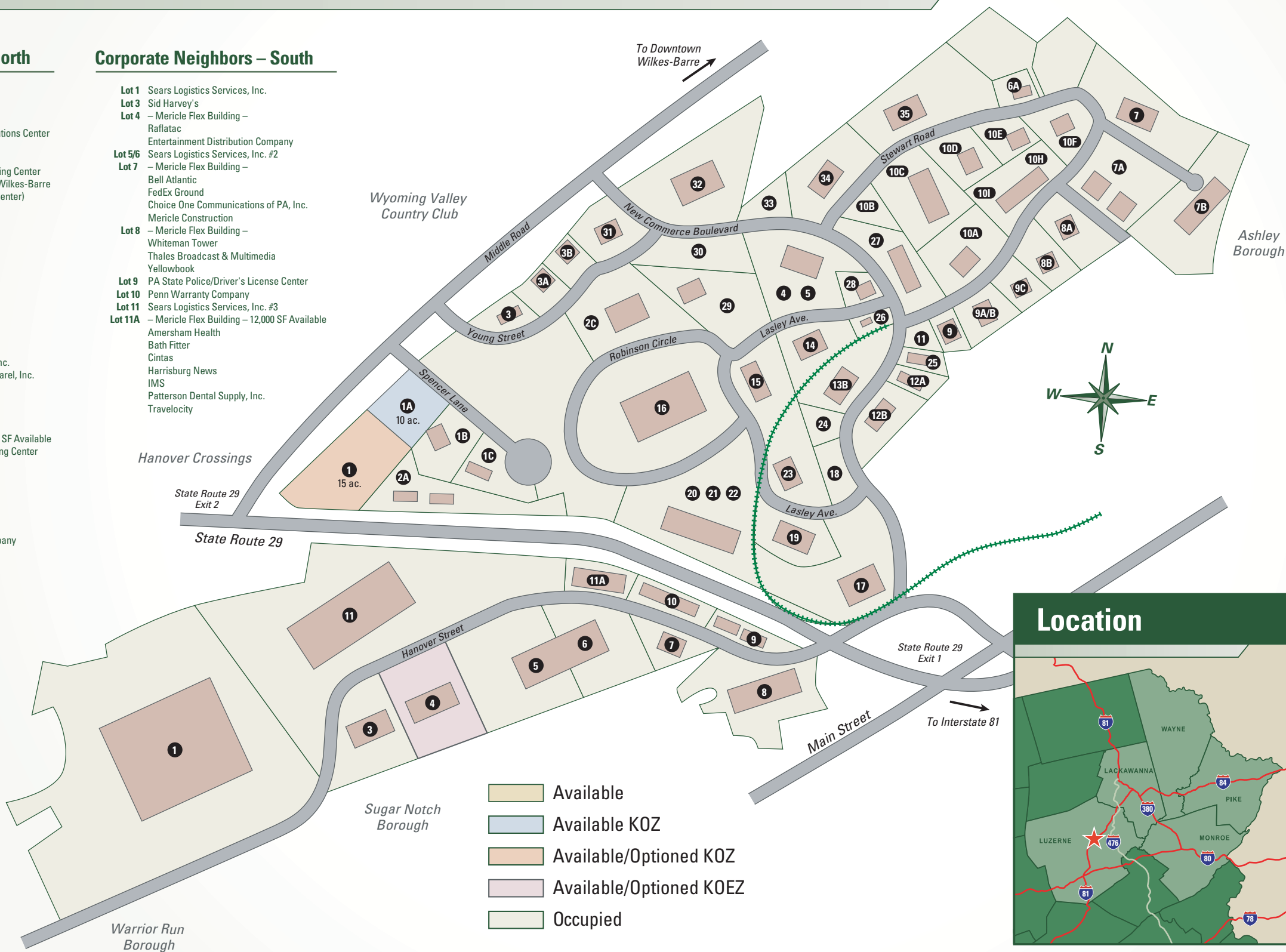

Location

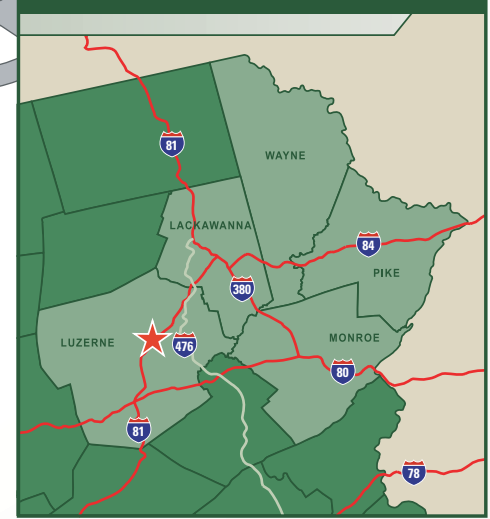

Contacts

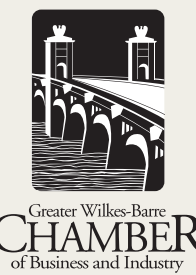

Greater Wilkes-Barre Chamber of Business and Industry

John L. Augustine, III
Senior Director of Economic and Entrepreneurial Development
570-823-2101
jaugustine@wilkes-barre.org

P.O. Box 5340
Wilkes-Barre, PA 18710
Phone: 570-823-2101
Fax: 570-822-5951
www.wilkes-barre.org

This project was financed (in part) by a grant from the Commonwealth of Pennsylvania, Department of Community and Economic Development.